

CEMOM
Moatti

ESTETIC 150[®]
UNIVERSAL CONCEALED HINGES
3D ADJUSTABLE

ESTETIC 150



ESTETIC 150

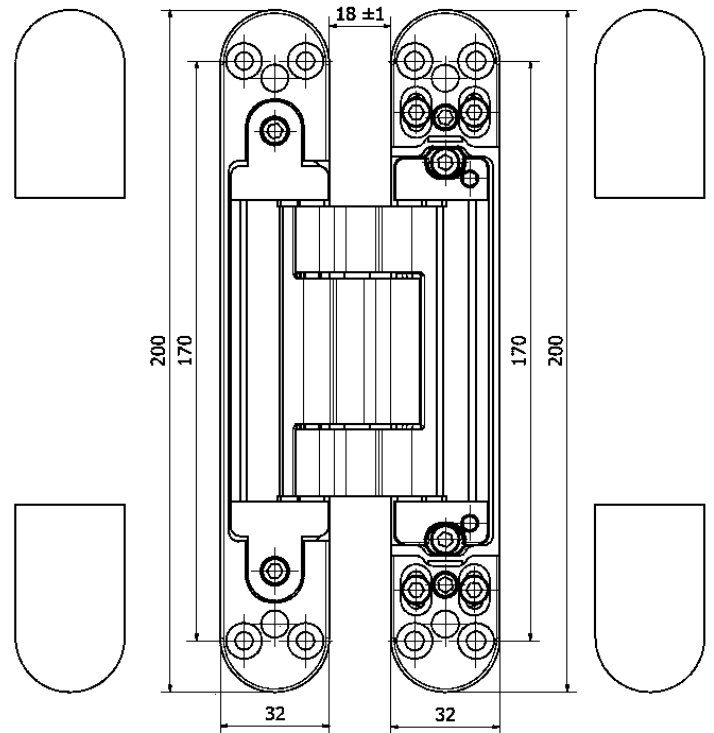

	Number of the hinges	width of the DOOR "L" [mm]			
		700	800	900	1000
Load capacity	2	193 kg	169 kg	150 kg	135 kg
	3	217 kg	190 kg	169 kg	152 kg
	4	232 kg	203 kg	180 kg	162 kg

Position of the hinge in relation to the required dimensions of the door and the frame

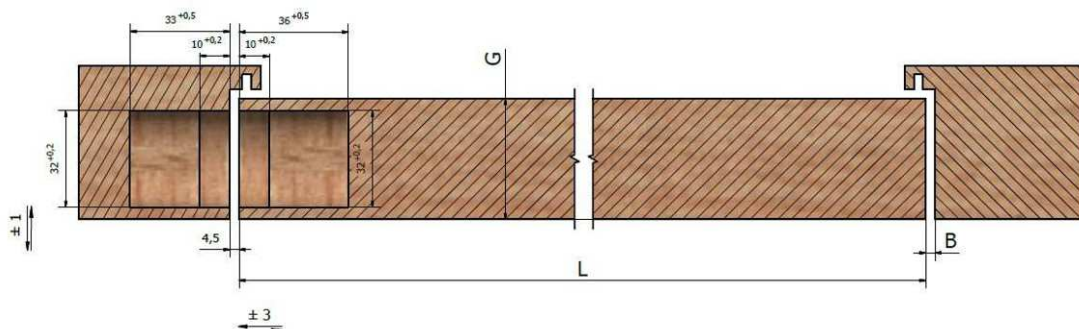

Dimensions of socket

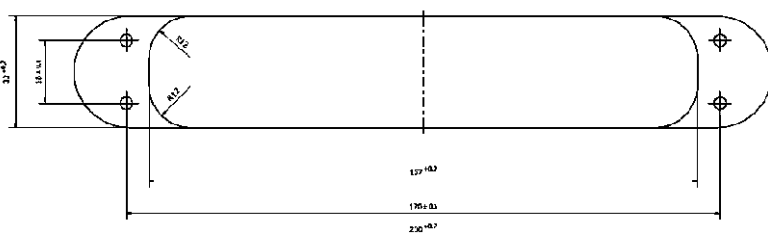

	Thickness of the DOOR "G"	width of the DOOR "L" [mm]			
		700	800	900	1000
Minimum slot "B"	40	4 mm	4 mm	3 mm	3 mm
	60	5 mm	4 mm	4 mm	4 mm
	80	6 mm	6 mm	5 mm	5 mm